

SHT-N, U/OVT-N INSTRUCTION MANUAL

LSis

⚠ Before installation, wiring, operation, maintenance and inspection of the device, be sure to read the operating instructions carefully to ensure proper operations.

Head office TEL: 82-2-2034-4870, FAX: 82-2-2034-4713
Home Page <http://www.lsis.com>

1. Ratings

- SHT-N: Mounting on the right side of BKN, used to trip the combined BKN by remote controlling device.
- U/OVT-N: Mounting on the right side of circuit breaker, actuate the combined device to trip in case of under-voltage or over-voltage, effectively prevent the device from closing operation under abnormal power voltage condition.

SHT-N	Rated voltage (Ue)	AC 110-415V, AC 24V
	Operate voltage range	70-100% Ue
U/OVT-N	Rated voltage (Ue)	AC 230V
	Over-voltage tripping range	280V \pm 5%
	Under-voltage tripping range	170V \pm 5%
Electro-mechanical endurance		10,000 operations
Terminal		M5 screw (cable up to 25mm ²)

2. Installation

1. On the OFF position, Remove Cap from BKN

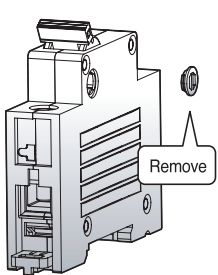

2. Push to reset

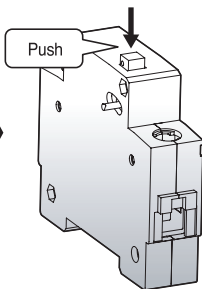

3. Assembly trip-lever of SHT-N or U/OVT-N to BKN carefully

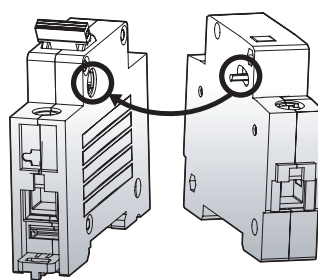

4. Tighten two screws on the diagonal position.

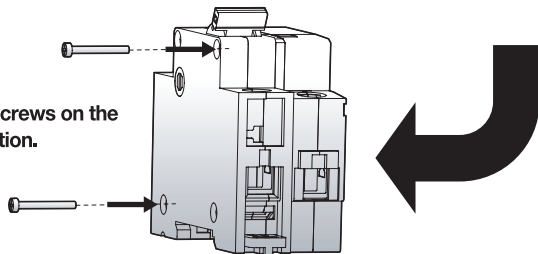

3. Safety Precaution

- ⚠ **DANGER:** Offending against the message will result in death or serious injury.
- ⚠ **CAUTION:** Offending against the message will result in minor injury or physical damage.

⚠ DANGER

- 1) Turn off the upstream circuit breaker before installing or service to prevent electric shocks and burns due to short circuit.
- 2) Do not touch and live naked terminals. It makes an electric shock.
- 3) Do not touch two live lines simultaneously. The circuit breaker does not operate even if an electric shock occurs.

⚠ CAUTION

- 1) Do not install the circuit breaker in place of environment with shock, high temperature, humidity, dust, corrosive gases, excessive vibration, etc. to prevent fire accidents and malfunction of the device.
- 2) Use the breaker in a range of the rated voltage and current shown on the name plate. Or it may cause malfunction.
- 3) Each terminal or conductor pole should be connected in parallel as shown below.

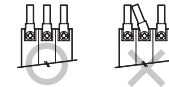

- 4) Be sure to ground the ground terminals of electrical devices.
- 5) When the circuit breaker trips of it self, remove the cause and turn the handle on. Or else, it may lead to the fire accident.
- 6) Do not modify the device unless it is permitted.
- 7) When the device become useless, it should be dispose of them as an industrial waste.
- 8) In order to fix MCB in DIN-Rail, Install fixing bracket on the both MCB side, After wiring.

4. Dimension

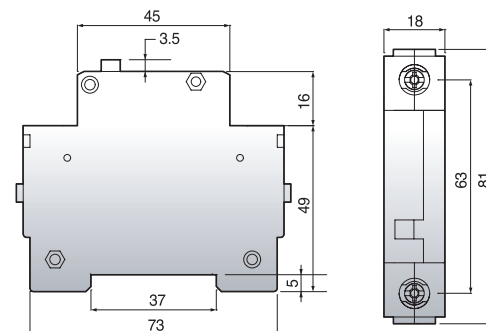

5. Appearance

